

COILS FOR VARIABLE AIR FLOW UNITS

SERIE
DC-BAH

FITTING

Fitting mode:

The DC-BAH series heating batteries are usually fitted at the bottom of the CL-VCL o CL-VCC series regulation boxes.

The box silencers house four filtering inserts M8, where as the batteries house four holes Ø10 for the screws. The use of washers is advised.

Fitting position:

The water will always have to enter from the lowest inlet and exit from the highest.

The batteries can be made with the water connections on the left of right in relation to the air flow direction. If this is not indicated, they will be made with the connections on the right side.

In correctly fitted models the connection for the exit will be the closest to the air entry side. The incorrect fitting of the battery entails a performance reduction of the heat exchange.

Precautions:

It is advisable to interject a suitable gasket between the box and the battery to eliminate air leaks.

Great care should be taken in handling the battery as the blades is composed of very thin blades easily bendable. Once filled, it is recommended to remove all remaining air by acting on the valve present on the higher duct.

If it is necessary to dismantle the battery, it is possible to empty is using the valve on the bottom duct.

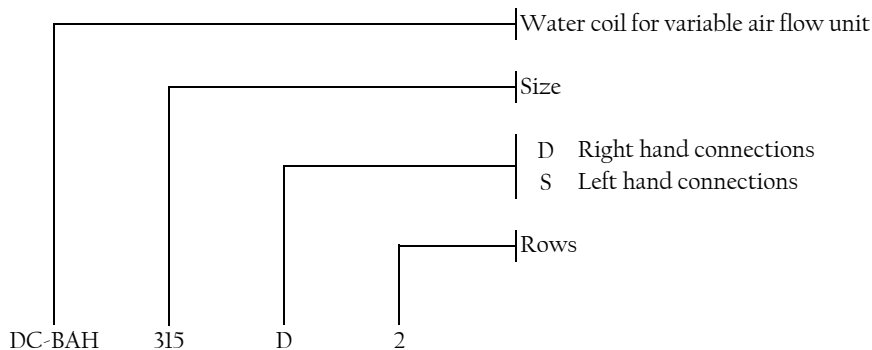
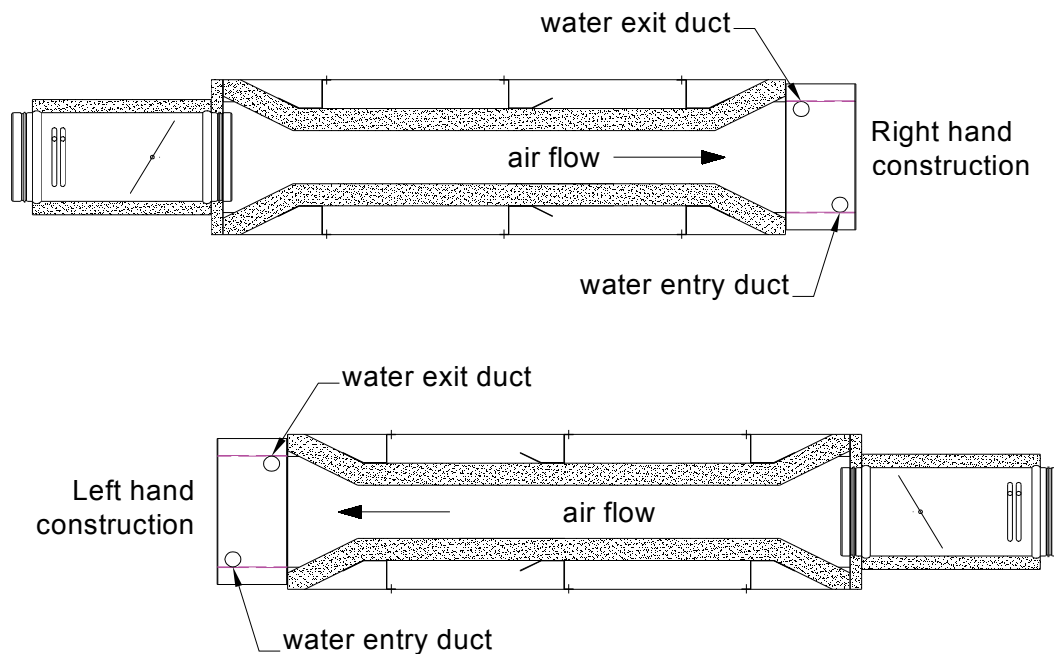

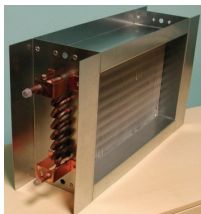

COILS FOR VARIABLE AIR FLOW UNITS

DC-BAH
SERIES

OVERALL DIMENSIONS

DC BAH 125 D2

DC BAH 160 D2

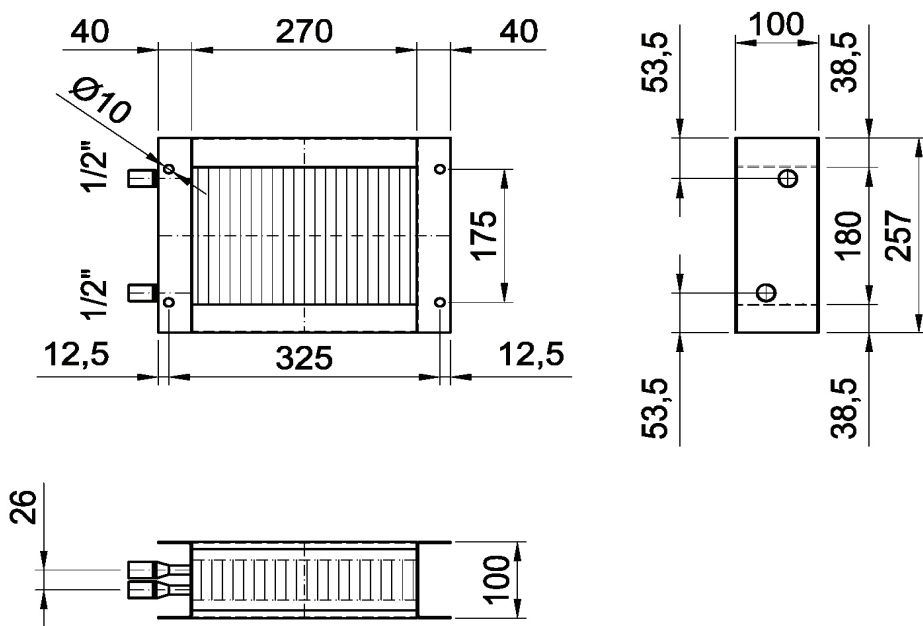

DC BAH 200 D2

DC BAH 250 D2

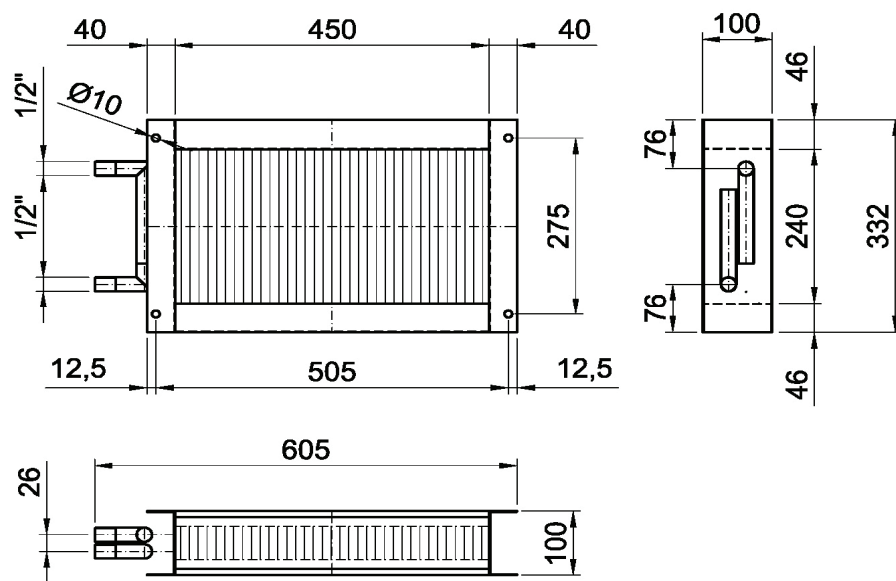

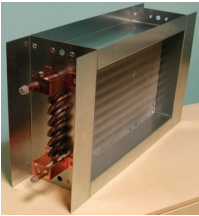

COILS FOR VARIABLE AIR FLOW UNITS

DC-BAH
SERIES

OVERALL DIMENSIONS

DC BAH 315 D2

DC BAH 355 D2

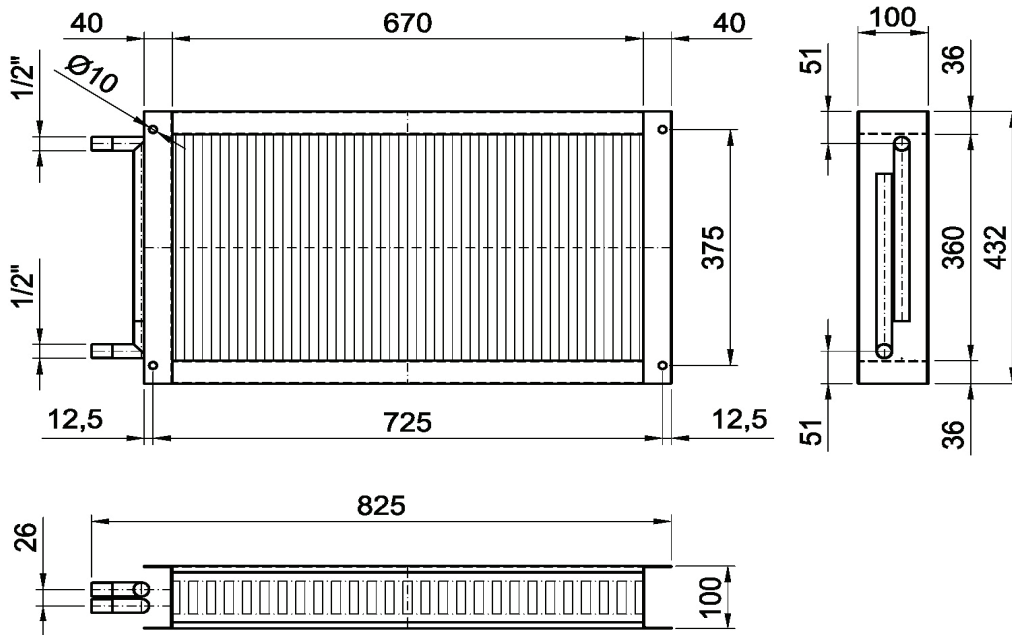

DC BAH 400 D2

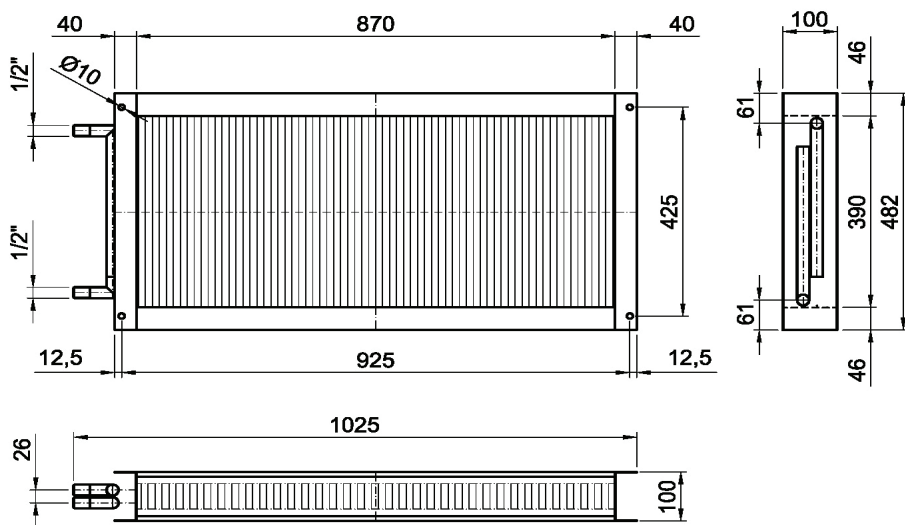

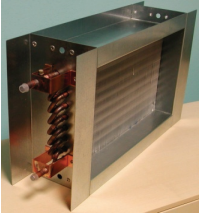

COILS FOR VARIABLE AIR FLOW UNITS

DC-BAH
SERIES

OVERALL DIMENSIONS

DC BAH 500 D2

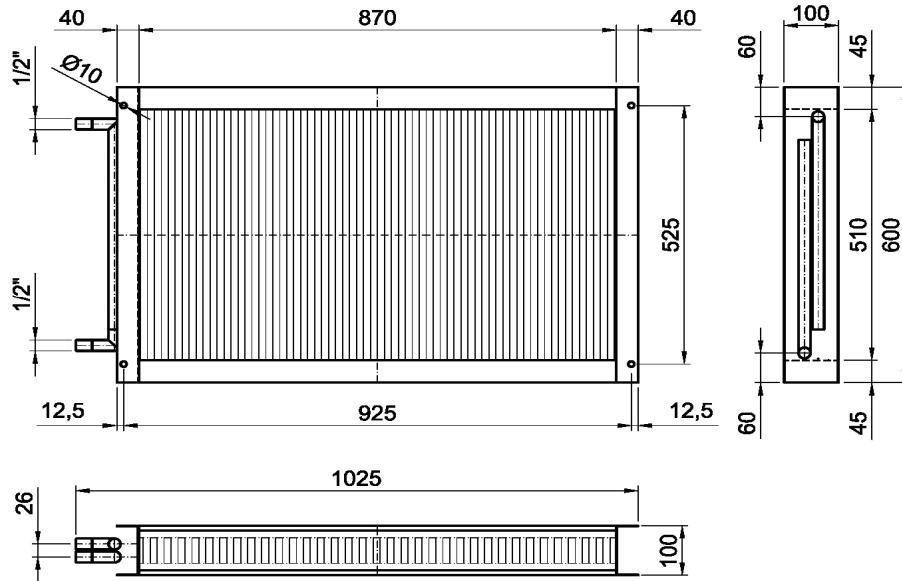

DC BAH 630 D2

