



# RESIDENTIAL EXTRACT GRILLES

## OVERVIEW

SERIES  
UR  
UQ  
URC

### CHARACTERISTICS

**Frame:** Made of extruded aluminium, width 25 mm, with rounded edges, built in four parts invisibly connected by mechanical assembly.

**Fins:** In extruded aluminium with 20 mm centre distance, hinged on a self-locking nylon runner incorporated in the frame.

**Cross reinforcement:** Provided on all openings with dimension L above 600 mm.

**Damper:** Made entirely of steel, with opposed movement multiple fins.

**Counter frame:** Rigid sheet steel construction.

### Grille wall installation

By means of screwless systems via clips and counter frame or with traditional screw system directly in the duct or on the wall.

### Grille ceiling installation

By grille anchoring in frame. Finish: available in natural anodized aluminium or with RAL 9010 powder coating.

**UR :** Residential extract grilles pitch 20 mm made of anodized extruded aluminium.

**UQ :** Residential extract grilles with square mesh, frame is made of anodized extruded aluminium, mesh is made of aluminium

**URCI :** Residential extract grilles pitch 20 mm made of anodized extruded aluminium with filterholder for filter FPI5

### UNSUITABLE ENVIRONMENTS

The aluminum products are not suitable for installation in environments with an atmosphere containing corrosive substances for this material and in particular containing chlorine, such as swimming pools, spas and some types of food industries.

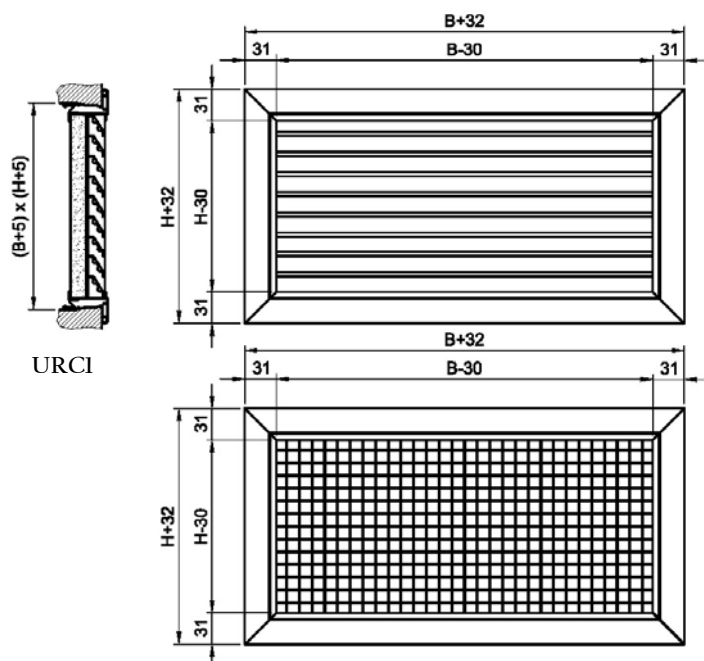
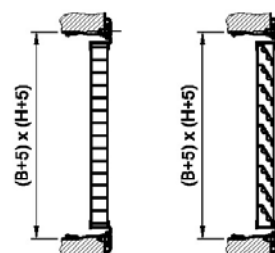
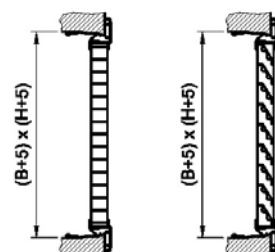
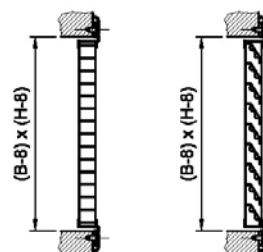
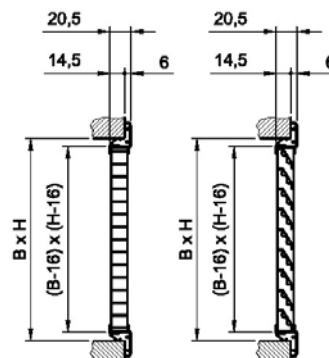



## RESIDENTIAL EXTRACT GRILLES

### OVERVIEW

SERIES  
UR 2  
UR 3  
UR 4  
UR 5

#### CHARACTERISTICS :

##### Frame

Made of extruded aluminium, width 25 mm, with rounded edges, built in four parts invisibly connected by mechanical assembly.

##### Fins

In extruded aluminium with 20 mm centre distance, hinged on a self-locking nylon runner incorporated in the frame.

##### Cross reinforcement

Provided on all openings with dimension L above 600 mm.

##### Damper

Made entirely of steel, with opposed movement multiple fins.

##### Counter frame

Rigid sheet steel construction.

##### Finish

Available in natural anodized aluminium or with RAL 9010 powder coating.

**UR2 :** Residential extract grilles pitch 20 mm made of anodized extruded aluminium, filterholder frame for filter media (initial thickness 15 mm), opening system: hinge on upper side (maximum angle 85°) and magnet on bottom side.

Installation on wall, not ceiling-mount

**UR3 :** Residential extract grilles pitch 20 mm made of anodized extruded aluminium, filterholder frame for filter media (initial thickness 15 mm), opening system: hinge on upper side (maximum angle 85°) and screws on bottom side.

Installation on wall or ceiling

**UR4 :** Residential extract grilles pitch 20 mm made of anodized extruded aluminium, filterholder frame for filter media (initial thickness 15 mm), opening system: hinge on upper side (maximum angle 85°) and knob on bottom side.

Installation on wall or ceiling

**UR5 :** Residential extract grilles pitch 20 mm made of anodized extruded aluminium, filterholder frame for filter media (initial thickness 15 mm), mounting on false ceiling, opening system with knobs (optional with screws).

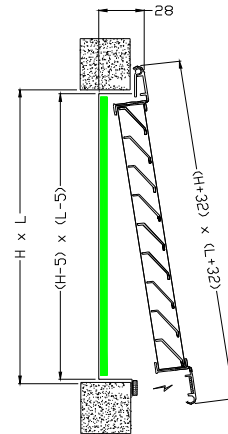

UR2: fixing with magnets

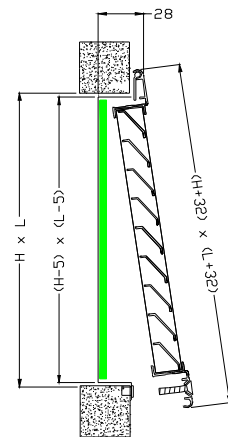

UR3: fixing with screws

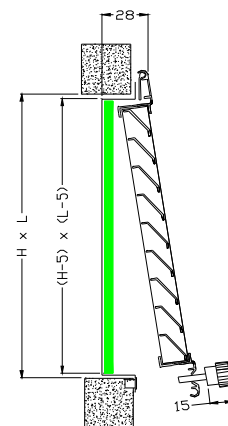

UR4: fixing with pommel

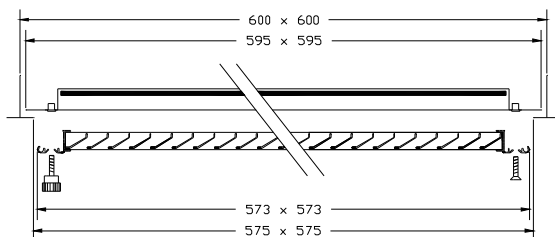

UR5: production for counter ceiling



## RESIDENTIAL EXTRACT GRILLES

### OVERVIEW

SERIES  
UR 12  
UR 13  
UR 14

#### CHARACTERISTICS :

##### Frame

Made of extruded aluminium, width 25 mm, with rounded edges, built in four parts invisibly connected by mechanical assembly.

##### Fins

In extruded aluminium with 20 mm centre distance, hinged on a self-locking nylon runner incorporated in the frame. Cross reinforcement

Provided on all openings with dimension L above 600 mm.

##### Damper

Made entirely of steel, with opposed movement multiple fins.

##### Counter frame

Rigid sheet steel construction.

##### Finish

Available in natural anodized aluminium or with RAL 9010 powder coating.

**UR12:** Residential extract grilles pitch 20 mm made of anodized extruded aluminium, filterholder frame for filter, thickness of filter frame from 3 to 15 mm, opening system: hinge on upper side (maximum angle 85°) and magnet on bottom side.

Installation on wall, not ceiling-mount

**UR13:** Residential extract grilles pitch 20 mm made of anodized extruded aluminium, filterholder frame for filter, thickness of filter frame from 3 to 15 mm, opening system: hinge on upper side (maximum angle 85°) and screws on bottom side. Installation on wall or ceiling

**UR14:** Residential extract grilles pitch 20 mm made of anodized extruded aluminium, filterholder frame for filter, thickness of filter frame from 3 to 15 mm, opening system: hinge on upper side (maximum angle 85°) and knob on bottom side. Installation on wall or ceiling

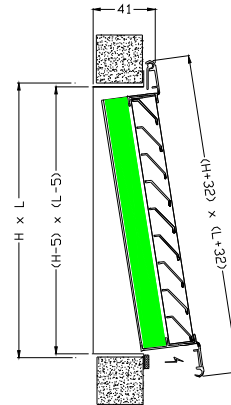

UR12: fixing with magnets

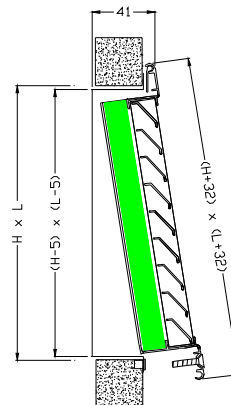

UR13: fixing with screws

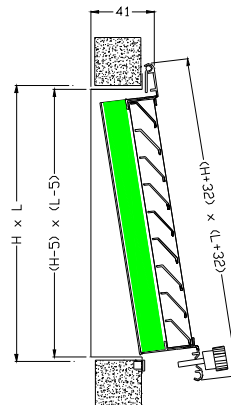

UR14: fixing with pommel



## RESIDENTIAL EXTRACT GRILLES

### OVERVIEW

SERIES  
UR 21  
UR 22  
UR 23  
UR 24

#### CHARACTERISTICS :

##### Frame

Made of extruded aluminium, width 25 mm, with rounded edges, built in four parts invisibly connected by mechanical assembly.

##### Fins

In extruded aluminium with 20 mm centre distance, hinged on a self-locking nylon runner incorporated in the frame.

##### Cross reinforcement

Provided on all openings with dimension L above 600 mm.

##### Damper

Made entirely of steel, with opposed movement multiple fins.

##### Counter frame

Rigid sheet steel construction.

##### Finish

Available in natural anodized aluminium or with RAL 9010 powder coating.

**UR21 :** Residential extract grilles pitch 20 mm made of anodized extruded aluminium, filterholder frame for filter media (initial thickness 15 mm), opening system: by clips on both sides.  
Installation on wall, not ceiling-mount

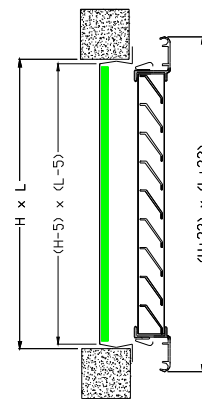

UR21: fixing with clips

**UR22 :** Residential extract grilles pitch 20 mm made of anodized extruded aluminium, filterholder frame for filter media (initial thickness 15 mm), opening system: by magnets on both sides.  
Installation on wall, not ceiling-mount

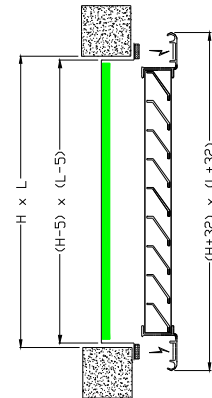

UR22: fixing with magnets

**UR23 :** Residential extract grilles pitch 20 mm made of anodized extruded aluminium, filterholder frame for filter media (initial thickness 15 mm), opening system: by screws on both sides.  
Installation on wall or ceiling

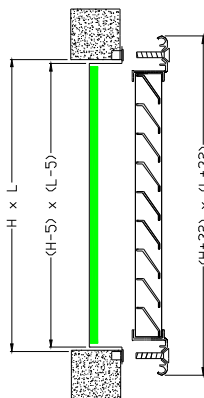

UR23: fixing with screws

**UR24 :** Residential extract grilles pitch 20 mm made of anodized extruded aluminium, filterholder frame for filter media (initial thickness 15 mm), opening system: by knobs on both sides.  
Installation on wall or ceiling

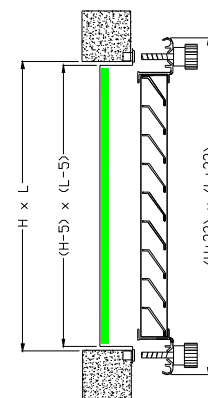

UR24: fixing with pommels



## RESIDENTIAL EXTRACT GRILLES

PERFORMANCE UR

UR  
SERIES

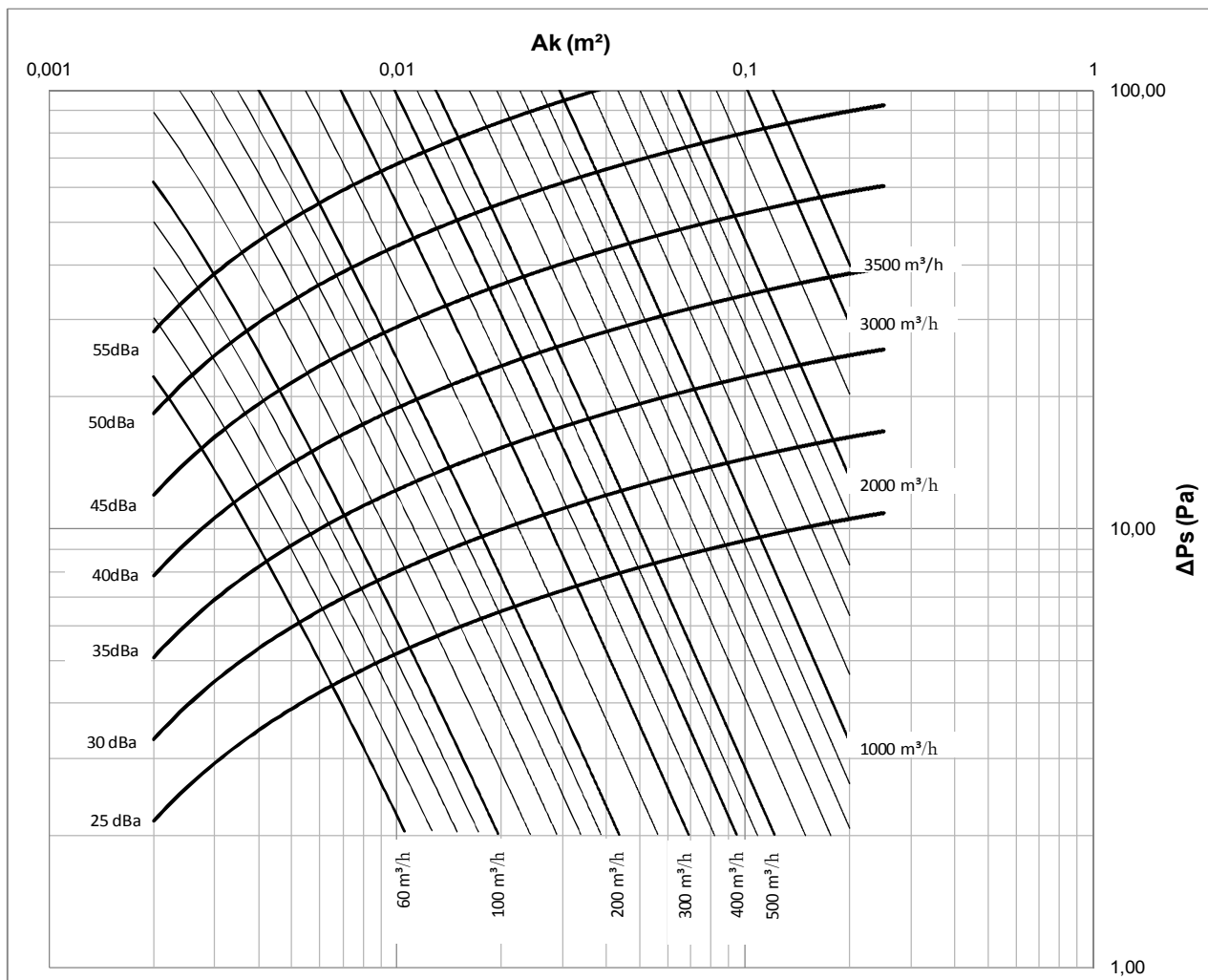

$A_k$ (m <sup>2</sup> )									
HEIGHT	BASE								
	200	300	400	500	600	700	800	900	1000
100	0,0026	0,0041	0,0056	0,0072	0,0087	0,0102	0,0118	0,0133	0,0148
150	0,0058	0,0093	0,0127	0,0161	0,0196	0,0230	0,0264	0,0299	0,0333
200	0,0091	0,0144	0,0198	0,0251	0,0304	0,0358	0,0411	0,0465	0,0518
250	0,0123	0,0196	0,0268	0,0341	0,0413	0,0486	0,0558	0,0631	0,0703
300	0,0156	0,0247	0,0339	0,0430	0,0522	0,0613	0,0705	0,0797	0,0888
350	0,0188	0,0299	0,0409	0,0520	0,0631	0,0741	0,0852	0,0963	0,1073
400	0,0221	0,0350	0,0480	0,0610	0,0739	0,0869	0,0999	0,1128	0,1258
450	0,0253	0,0402	0,0551	0,0699	0,0848	0,0997	0,1146	0,1294	0,1443
500	0,0285	0,0453	0,0621	0,0789	0,0957	0,1125	0,1293	0,1460	0,1628
550	0,0318	0,0505	0,0692	0,0879	0,1066	0,1252	0,1439	0,1626	0,1813
600	0,0350	0,0556	0,0762	0,0968	0,1174	0,1380	0,1586	0,1792	0,1998



## RESIDENTIAL EXTRACT GRILLES

PERFORMANCE UQ

UQ  
SERIES

The below diagram shows the total pressure and acoustic pressure as a function of air flow rate.

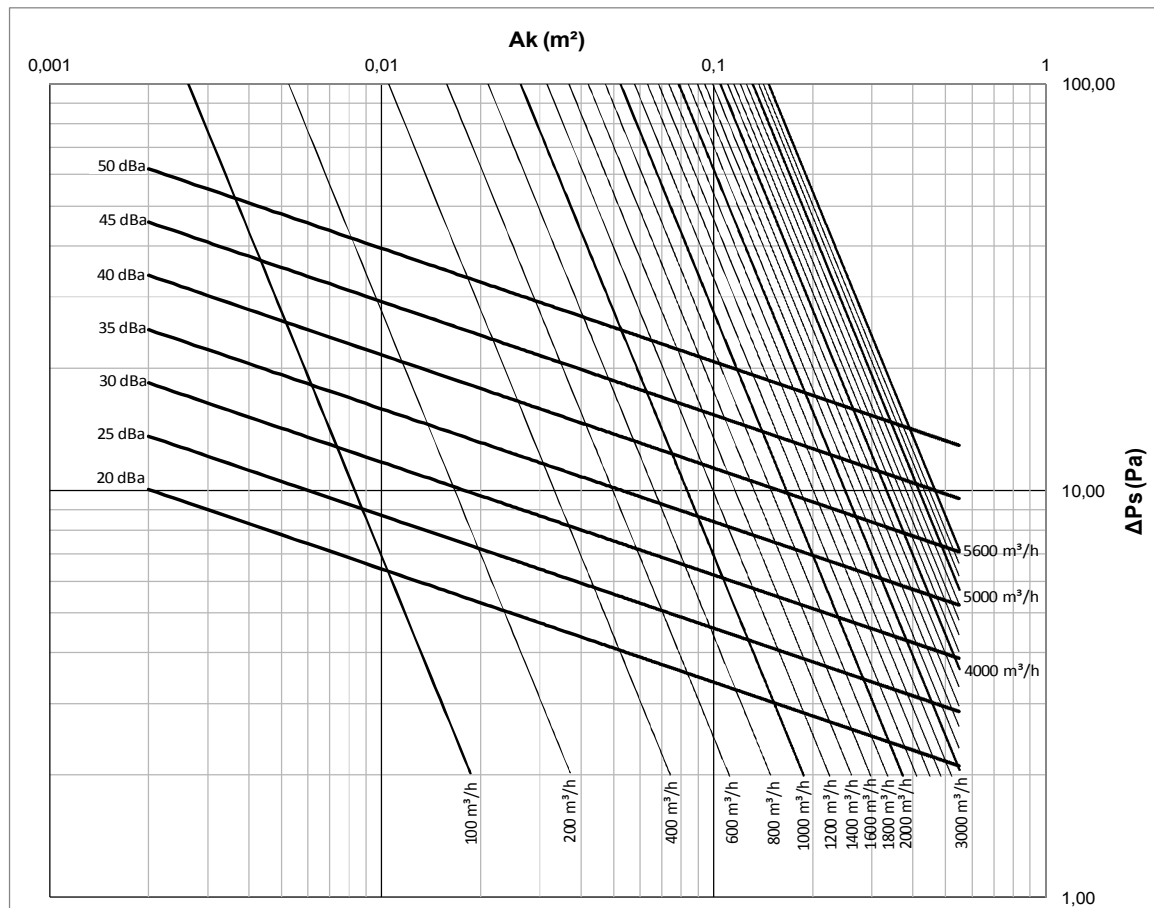

Ak values (m <sup>2</sup> )									
H (mm)	L (mm)								
	200	250	300	350	400	500	600	800	900
100	0,015	0,019	0,024	0,028	0,033	0,042	0,052	0,070	0,079
150	0,024	0,031	0,038	0,045	0,052	0,065	0,079	0,107	0,121
200	0,033	0,042	0,052	0,061	0,070	0,089	0,107	0,144	0,163
300	0,052	0,065	0,079	0,093	0,107	0,135	0,163	0,218	0,246
400	0,070	0,089	0,107	0,126	0,144	0,181	0,218	0,292	0,329
500	0,089	0,112	0,135	0,158	0,181	0,227	0,274	0,366	0,412
600	0,107	0,135	0,163	0,190	0,218	0,274	0,329	0,440	0,496

CORRECTION FACTORS OF TOTAL PRESSURE $P_t$ (Pa) due to calibrating gate			
Position	Open	Opening 45°	Closed
Total pressure $P_t$	x 1.1	x 3.2	x 15

CORRECTION FACTORS OF ACOUSTIC LEVEL $L_a$ (dB(A)) due to calibrating gate			
Position	Open	Opening 45°	Closed
Acoustic pressure $L_a$	+ 0	+ 15	+ 35



## RESIDENTIAL EXTRACT GRILLES

HOW TO ORDER

UR  
UQ  
SERIES

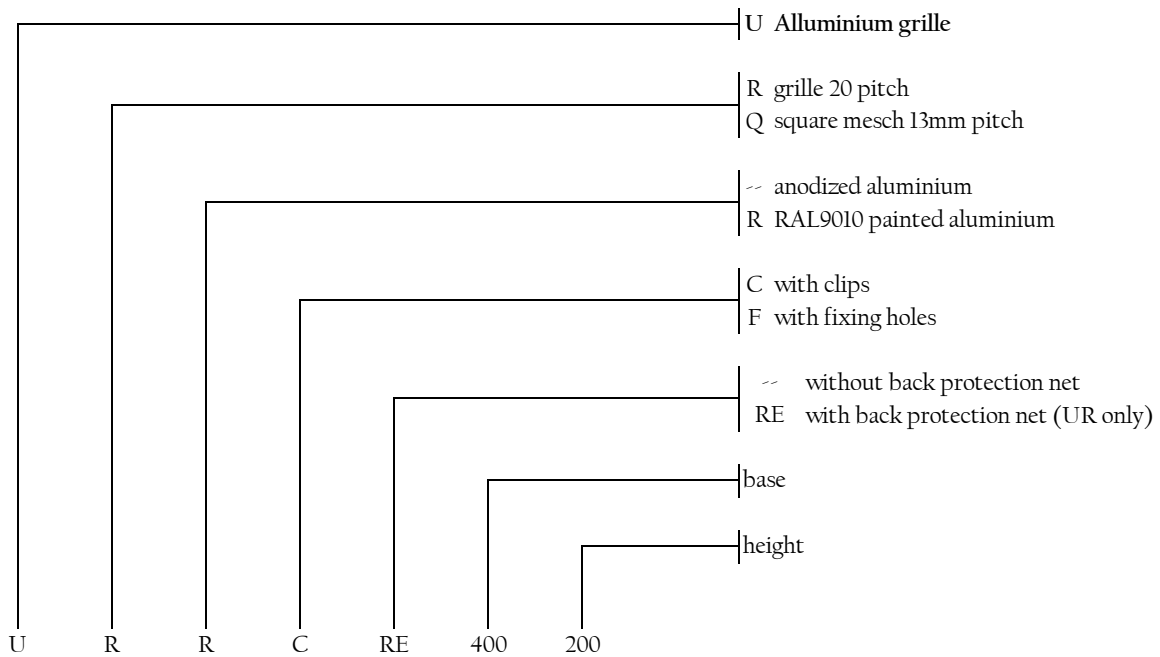



## RESIDENTIAL FILTER HOLDER EXTRACT GRILLES

HOW TO ORDER

UR  
UQ  
SERIES

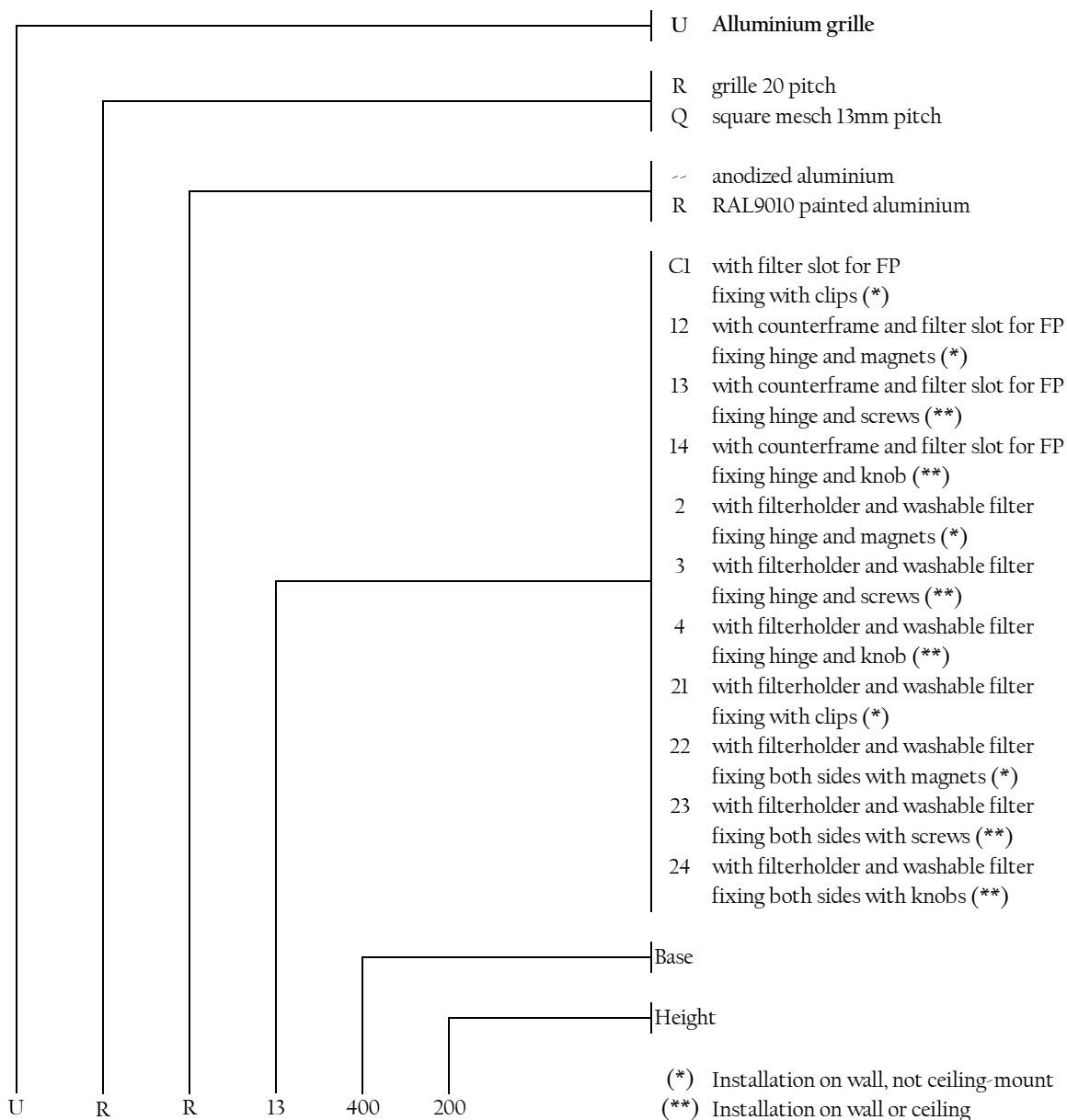

With filter slot for FP



With filtering sheet





## RESIDENTIAL GRILLES

### ACCESSORIES

SERIES  
UR  
UQ  
URC



PP30 Plenum with rear connection  
insulated and non insulated version



PP40 Plenum with lateral connection  
insulated and non insulated version



SC Control damper



UTC Counterframe



## PLENUM FOR VENTILATION GRILLES

PP 30  
SERIES

### TECHNICAL CHARACTERISTICS

L	H	A	N°	S
200	100	140	1	80
300	100	140	1	80
400	100	140	1	80
500	100	140	2	80
600	100	140	2	80
700	100	140	2	80
800	100	140	2	80
200	150	180	1	127
300	150	180	1	127
400	150	180	1	127
500	150	180	2	127
600	150	180	2	127
700	150	180	2	127
800	150	180	2	127
900	150	180	2	127
1000	150	180	2	127
200	200	220	1	150
300	200	220	1	150
400	200	220	1	180
500	200	220	1	180
600	200	220	2	150
700	200	220	2	150
800	200	220	2	150
900	200	220	2	180
1000	200	220	2	180
200	250	220	1	200
300	250	220	1	200
400	250	220	1	200
500	250	220	1	200
600	250	220	2	150
700	250	220	2	150
800	250	220	2	150
900	250	220	2	180
1000	300	220	2	180
300	300	260	1	250
400	300	260	1	250
500	300	260	1	250
600	300	260	2	160
700	300	260	2	160
800	300	260	2	160
900	300	260	2	200
1000	300	260	2	200
400	400	260	1	350
500	400	260	1	350
600	400	260	2	160
700	400	260	2	160
800	400	260	2	160
900	400	260	2	200
1000	400	260	2	200
515	515	150	1	250
563	563	270	1	350

PP 30

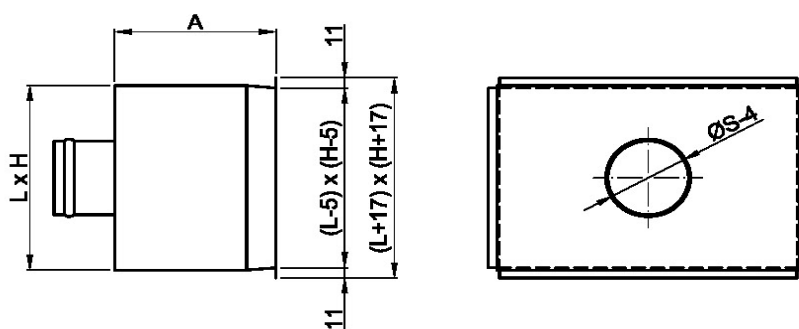

STANDARD GRILLE

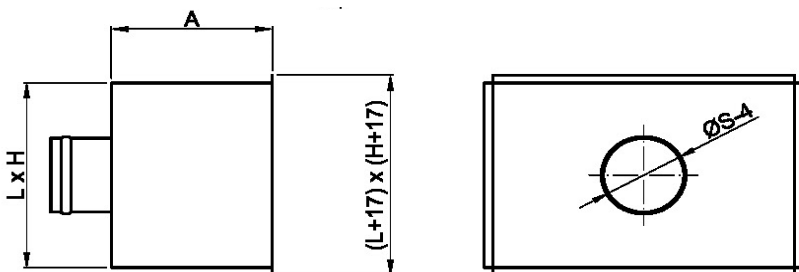

GRILLE WITH FILTERHOLDER FRAME

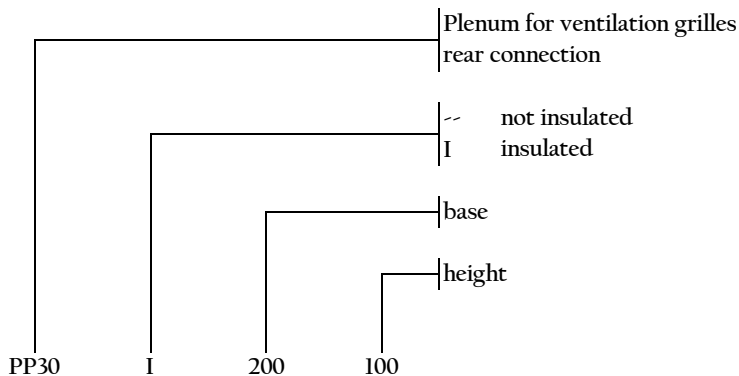

For S = 125 - 160 - 200 - 250 connection in ABS - steel on request  
For other diameters connection in steel



## PLENUM FOR VENTILATION GRILLES

PP 40  
SERIES

### TECHNICAL CHARACTERISTICS

L	H	A	B	C	N°	S
200	100	200	70	80	1	100
300	100	250	95	80	1	150
400	100	250	95	80	1	150
500	100	300	120	80	1	200
600	100	300	120	80	1	200
700	100	350	145	80	1	250
800	100	350	145	80	1	250
200	150	250	95	80	1	150
300	150	300	120	80	1	200
400	150	300	120	80	1	200
500	150	350	145	80	1	250
600	150	350	145	80	1	250
700	150	350	145	80	1	250
800	150	415	178	80	1	315
900	150	415	178	80	1	315
1000	150	415	178	80	1	315
200	200	250	95	80	1	150
300	200	250	95	80	1	150
400	200	350	145	80	1	250
500	200	350	145	80	1	250
600	200	415	178	80	1	315
700	200	415	178	80	1	315
800	200	415	178	80	1	315
900	200	450	195	80	1	350
1000	200	450	195	80	1	350
200	250	300	120	80	1	200
300	250	300	120	80	1	200
400	250	350	145	80	1	250
500	250	350	145	80	1	250
600	250	415	178	80	1	315
700	250	415	178	80	1	315
800	250	415	178	80	1	315
900	250	450	195	80	1	350
1000	250	450	195	80	1	350
300	300	350	145	80	1	250
400	300	415	178	80	1	315
500	300	450	195	80	1	350
600	300	450	195	80	1	350
700	300	450	195	80	1	350
800	300	450	195	80	1	350
900	300	500	220	80	1	400
1000	300	500	220	80	1	400
400	400	450	195	80	1	350
500	400	450	195	80	1	350
600	400	450	195	80	1	350
700	400	450	195	80	1	350
800	400	450	195	80	1	350
900	400	500	220	80	1	400
1000	400	500	220	80	1	400
515	515	320	145	50	1	250
563	563	450	195	80	1	350

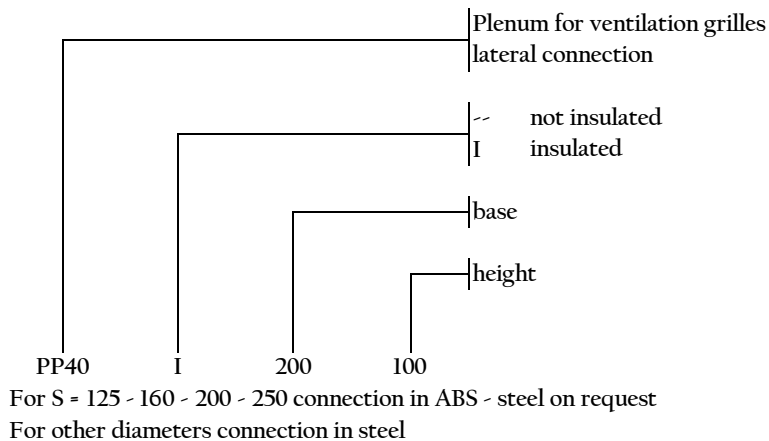
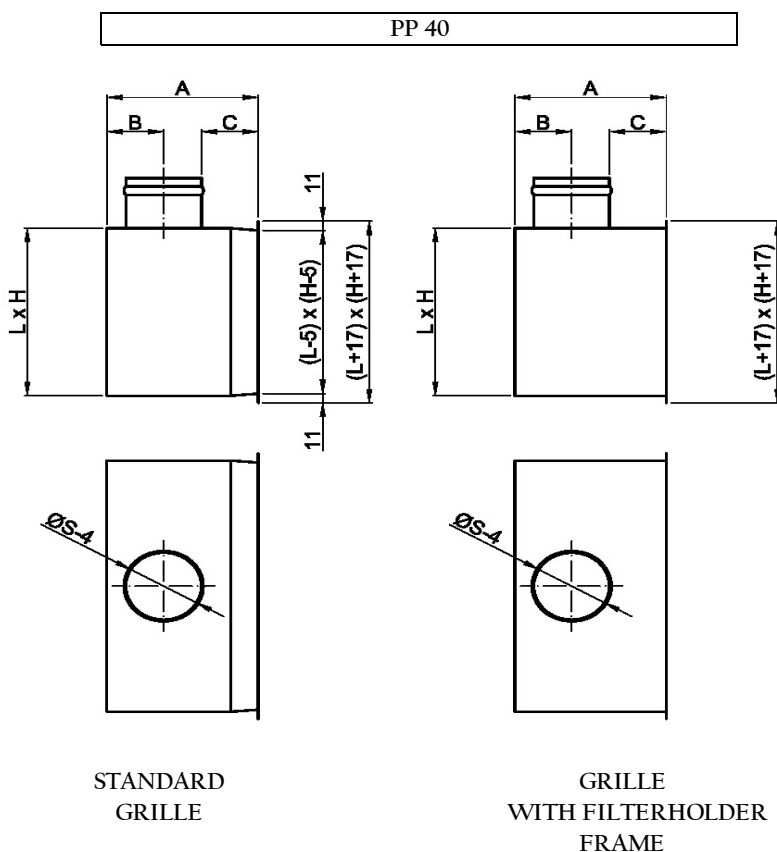



## CONTROL DAMPERS

## SC SERIES

### OVERVIEW TECHNICAL CHARACTERISTICS

#### OVERVIEW AND CHARACTERISTICS :

The contrast control dampers of SC series can be fitted to UF KG UM UR GI KN e CR-KN series . They are held in place by special patented clips, designed both for fitting the damper to the grill and for fitting it on a false frame.

The SC series dampers are made entirely of galvanised steel and have a mechanism for moving and closing all the blades simultaneously.

This mechanism is a simple longitudinal plate that links all the blades, and can be removed by unscrewing a nut using a screwdriver. The careful design, precise assembly, and the quality of the materials used, make this an economical, practical, and efficient component.

Contrast control damper- dimensions that can be created in a single solution

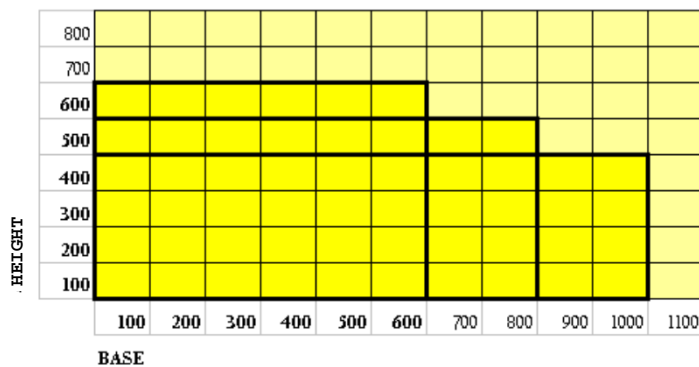

Contrast control damper - overall dimensions

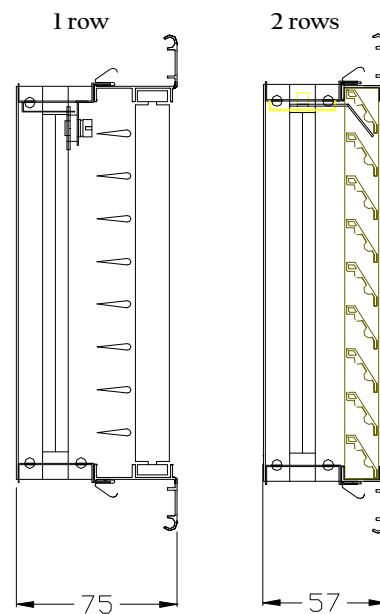

Contrast control damper -detail of patented fixing clips





## COUNTERFRAMES FOR SUPPLY AND RETURN GRILLES

UTC  
SERIES

### OVERVIEW

#### OVERVIEW

The UTC series counterframes used for supply and return grilles are a strong frame on which the fixing clips can rest. They are required if the grilles need to be frequently removed for cleaning, inspection, filter changing and other similar jobs. The UTC counterframes can be installed both next to steel ducts and on masonry walls.

Bendable parts are placed inside the fixing agent of the wall and a frame that will be completely hidden from the frame of the grille itself, for fixing by means of screws or rivets to the duct wall.

The use of the counterframe on the side of the steel duct allows the use of grilles with fixing clips rather than with screws, therefore allowing to undertake jobs that require removing and reinstalling the grille with the up most simplicity without the need of tools.

The use of the counterframe on masonry walls allows for an almost unlimited number of removals and replacements of the grille without ever damaging or wearing-out the border of the hole made in the wall. The position of the grille can therefore be maintained, precise and secure.

#### TECHNICAL CHARACTERISTICS

The UTC Series counterframes are made of four separate parts, of galvanized carbon steel sheet, fixable to each other without the need of tools. The parts are completely interchangeable as the particular system of connection eliminated the need to distinguish between horizontal and vertical parts and with between left and right parts.

As shown in the illustration, the necessary space for the counterframe needs to be 5mm more than the nominal size of the grille.

The parts are supplied unassembled, the complete interchangeability helps to easily manage the parts kept in stock.

#### AVAILABLE SIZES

The available sizes for each part range from 100mm up to a maximum of 1400mm, in multiples of 50mm.

Special sizes are also available on request.

By composing the various sizes, all the necessary sizes are achievable.

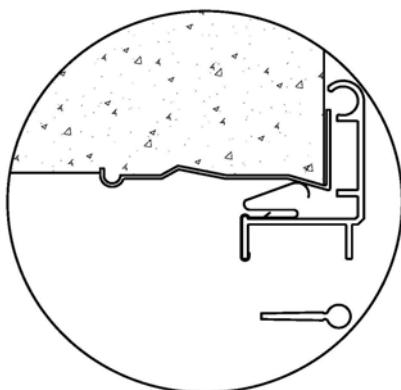

Mounting with single deflection grille

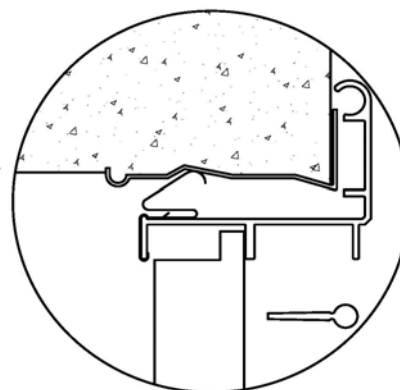

Mounting with double deflection grille



## COUNTERFRAMES FOR SUPPLY AND RETURN GRILLES

UTC  
SERIES

### OVERVIEW

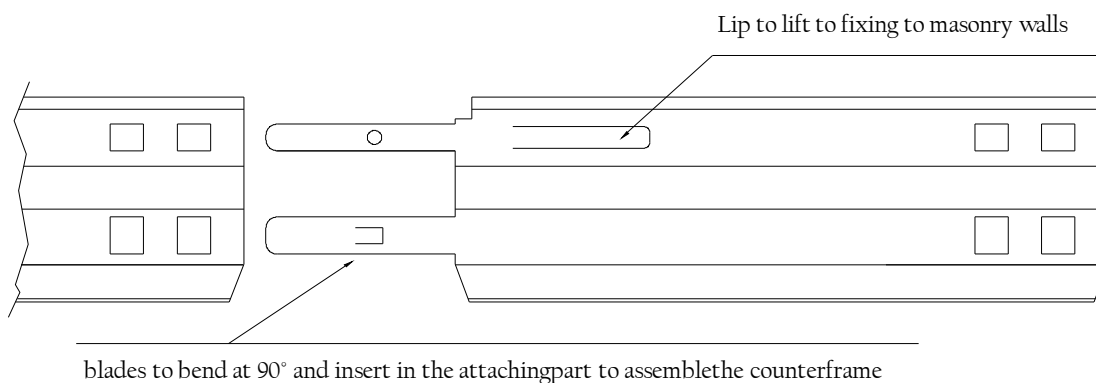

#### Detail of the fixing method between parts

This system allows to quickly assemble the counterframe, even during the construction phase.

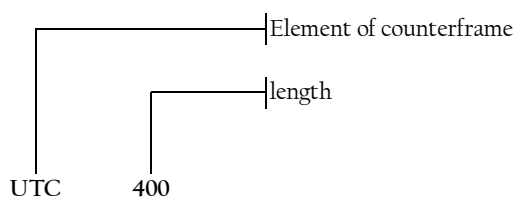

#### Example:

To order a counterframe for a 400x200mm grille, request:

UTC-400 - 2 pieces

UTC-200 - 2 pieces

To order a counterframe for a 300x300 grille, request:

UTC-300 - 4 pieces

COUNTERFRAME SIZES WITH AVAILABLE PARTS KEPT IN STOCK															
HEIGHT H	1000														
	900														
	800														
	700														
	600														
	563														
	500														
	450														
	400														
	350														
	300														
	250														
	200														
	150														
	100														
		100	150	200	250	300	350	400	450	500	563	600	700	800	900
		BASE B													

The 563x563 size is for grilles with a 595x595mm outside frame measurement, used for modular counterceilings.